

GLS40

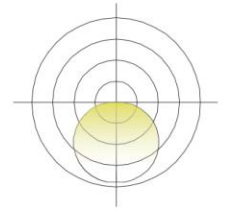

LE40FD



LE40 is a combination of elegant appearance and structure design, innovative light and heat design, new material and new technology and intelligent control technology. A professional lamp can be widely used in the main lighting of indoor space.



- AL6063-T5 aluminum profile with high-quality surface treatment;
- LM80 certified light source, life > 50000h;
- Built-in efficient and safe flicker-free dimming power supply ,Support 0-10V dimming or Dali dimming
- Recessed (with trim) installation.

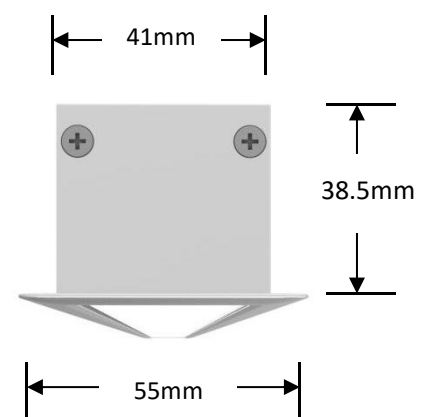

Optical & electronic data:

Model	Size	CCT	Flux (lm)	CRI	Beam angle	Input voltage	Dimming	PF	Power (w)	Efficiency (lm/w)
GLS-LE40FDXBS1200-T38NW8B-DC	1160mm	3000K	4130lm	>80	110°	200~240VAC 50Hz/60Hz	0-10V/D ALI	>0.9	38W	109
		3500K	4220lm							111
		4000K	4300lm							113
GLS-LE40FDXBS1500-T48NW8B-DC	1445mm	3000K	5160lm	>80	110°	200~240VAC 50Hz/60Hz	0-10V/D ALI	>0.9	48W	108
		3500K	5270lm							110
		4000K	5380lm							112
GLS-LE40FDXBS1800-T56NW8B-DC	1730mm	3000K	6200lm	>80	110°	200~240VAC 50Hz/60Hz	0-10V/D ALI	>0.9	56W	111
		3500K	6320lm							112
		4000K	6450lm							115
GLS-LE40FDXWS2300-T76NW8B-DC	2300mm	3000K	8260lm	>80	110°	200~240VAC 50Hz/60Hz	0-10V/D ALI	>0.9	76W	112
		3500K	8430lm							113
		4000K	8600lm							116

Remark:

- 1、the output data is based on the testing result of 1165mm luminaires ;
- 2、the tolerance of output data can be vary up to 10%;
- 3、the output data is typical value;

◆luminaire with Diffuser (GLS-LE40FD)

AAI Figure

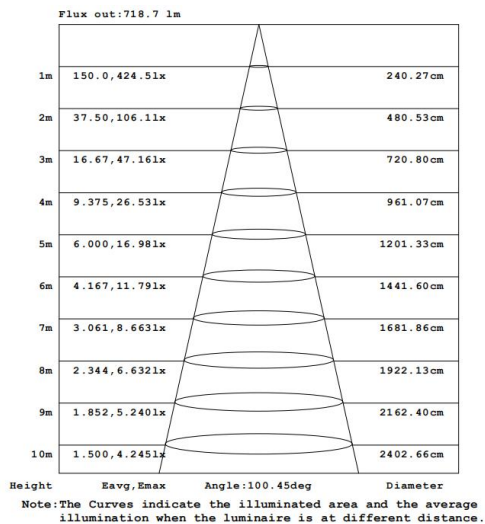

Luminous intensity distribution diagram

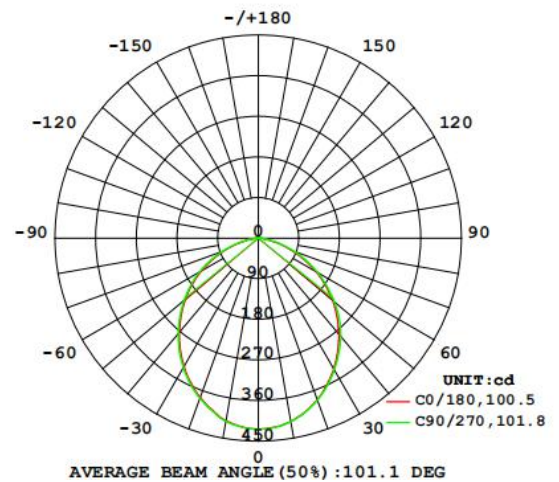

Packing:

◆ The whole package

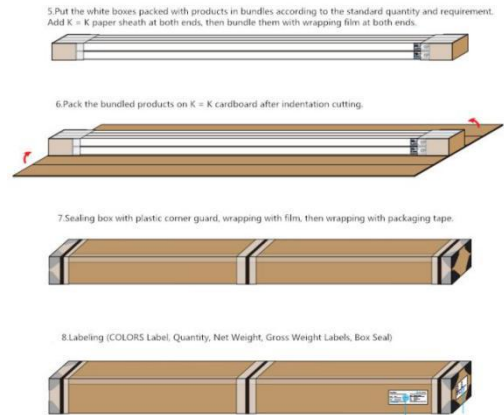
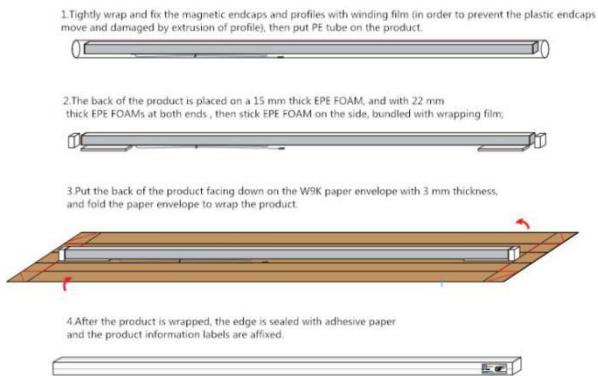

Model	Type	Demension (individual package)	Pcs /bundle	NW (Kg)	GW (Kg)	Demension (whole package)	CBM (m³)
GLS-LE40FDXBS1200-T38XX8B-DC	Individual Packing	1240*116*105mm	6	12	16.7	1260*272*235mm	0.08
GLS-LE40FDXBS1500-T48XX8B-DC		1540*116*105mm	6	15	20.1	1560*272*235mm	0.1
GLS-LE40FDXBS1800-T56XX8B-DC		1840*116*105mm	6	18	24	1860*272*235mm	0.12
GLS-LE40FDXWS2300-T76XX8B-DC		2440*116*105mm	6	24	32	2460*272*235mm	0.16

◆ Description about label information

GLS-LE40			
Luminous flux: 3500 LM Power(Typ): 38W CCT: 4000K CRI: >80 Input voltage: 200~240 VAC Frequency: 50/60Hz		Type: Luminaire Part NO: GLS-LE40FDXWS1200-T38NW8B-DC SO: YO17050147 NO: ZWL170510-0380 Color: White Power factor: >0.95 Cover type: Diffuser Size: 41x38.5x1146mm Date: 20200601	
www.colorsled.com			



Ordering code:

Category	Installation	Section Size	Diffuser Shape	Diffuser Nature	Carrier Style	Profile Color	End Cap Style	Length	-Light Source Type	Type Power of Luminaire	CCT	CRI	Power Type	Package	Label Type
GLS40	Recessed	40 Series	Flat	Diffuser	No	White	Standard End Cap	1160mm	-Constant Current Rigid	38W	3000K	CRI>80	0-10V	Individual Packing	COLORS
GLS	LE	40	F	D	X	W	S	1200	T	38	WW	80	B	-D	C
						1445mm		48W		3500K					
						Black		1500		48	PW		DALI		S
						B		1730mm		56W	4000K				
						1800		56		NW	A				
						Silver		2300mm					72W		
						S		2300		72					
GLS	-LE	40	F	D	X	W	S	1200	-T	38	NW	8	B	-D	C

Attentions:

- ◆ Please install the product in the right environment as much as possible;
- ◆ Please be careful during operation. Do not touch the AC power supply in case of electric shock;
- ◆ Check the current through the circuit, such as the surge occurs when press the switch does not exceed the maximum rated current, please insert the appropriate protection circuit;
- ◆ This product is sensitive to static electricity, and please special attention. In particular, it will damage the product when the static electricity is more than absolute maximum rated current and voltage, please make a countermeasures to avoid the damage of the static electricity and surge when using the product.

